



# VEILUX®

## EXPLOSION PROOF PAN / TILT / ZOOM CAMERA

### SVEX-Q15

#### DIMENSION:

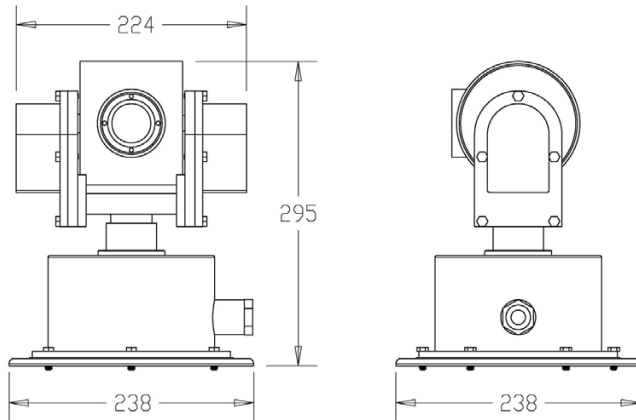

This SVEX-Q15 EXPLOSION PROOF PAN TILT ZOOM CAMERA adopts advanced production techniques and matured quality management system to make its excellent quality performance and appearance a leading position in explosion proof monitoring products. It can be used in flammable and explosive environment.

Strictly according to European Directive EC/94/9 and EN50014, Standards of GB3836.1-2000 GB3836.1—2000 Electrical apparatus for explosive atmosphere: General requirements, GB3836.2-2000 Electrical apparatus for explosive atmosphere: Flameproof 'd' and GB12476.1-2000 Electrical apparatus for explosive dust: Using enclosure and limiting surface temperature for protecting electrical apparatus It can be used in petroleum, chemical industry, port, mine, army and several other location.

SVEX-Q15 with high performance color integrated camera, 23X optical lens, 10X digital zoom could adjust pan tilt speed according to lens location to keep a clear quality image. It owns low lux technique and color B/W auto change, digital picture up/down and freeze function. SVEX-Q15 with multiple protocols to respond different control directives, its body moves 360° pan turning continuously and tilt -90° ~ +30°, with 64 presets to work in any extreme weather conditions.



# VEILUX®

*The Art of Surveillance*

3015 Eagle Drive, Suite 100, Grand Prairie, Texas 75052  
Local Number: (214) 635-4855 / Fax: (928) 437-6270  
sales@veilux.net  
www.veilux.net



# VEILUX®

## EXPLOSION PROOF PAN / TILT / ZOOM CAMERA

### SVEX-Q15

#### FEATURES:

Input Voltage	100 ~ 240VAC, 50/60Hz	Min. Focus	0.01m (tele) / 1.0m (far)
Working Current	≤300mA	View Angle	54° (wide) / 2.5° (far)
Power Consumption	<50W	Signal Process	No. 6 DSP
Communication	RS-485	Low Lux	0.1 Lux (Color) / 0.02 Lux (Black)
Communication Speed	Multiple, Could Be Set	TVL	480 (Color) / 600 (Black / White)
Communication Protocol	Multiple, Could Be Set	SNR	>50dB
Address Code	256	Video Output	BNC Joint / 1.0±0.2 Vp-p / 75Ω
Preset Position	128	Material	Stainless 304 or 316L
Preset Accuracy	≤0.1°	IP Level	IP-67
Electric Connection	6-Core Cable for Control, Power and Video	Pan	0 ~ 360° Continuously
Brand	HITACHI Zoom Module 23x	Tilt	-90° ~ +30°
Mode	PAL / NTSC	Pan Speed	0.1°/S ~ 60°/S
Scan	Line Scan	Tilt Speed	0.1°/S ~ 60°/S
CCD	1/4" SONY CCD	Unit / Ship Weight	22Kg / 25Kg
Line Scan	15.625 KHz	Mounting	Ceiling
Site Scan	50 Hz	Air Pressure	86 ~ -106KPa
Pixel	470,000 / 795(H) x 596(V)	Environment	-15°C ~ +50°C
Lens	High Performance / 23X Optic Zoom / Auto Focus / F1.6, f=3.6 ~ 82.8mm / 10X Digital Zoom, Total 230X	Temperature	
		Relative Humidity	≤95% RH (+25°C)

#### ESSENTIAL ACCESSORIES:



SVEX-M15 is a bracket designed for SVEX-Q15 camera that is wall mounting and load to 100kg.

#### OPTIONAL ACCESSORIES:

SVEX-JXD assist equipments of explosion proof television and communication system.



# VEILUX®

*The Art of Surveillance*

3015 Eagle Drive, Suite 100, Grand Prairie, Texas 75052  
Local Number: (214) 635-4855 / Fax: (928) 437-6270  
sales@veilux.net  
www.veilux.net